

G3-M4-Lesson 15

Use a ruler to measure the side lengths of each numbered room in the floor plan in centimeters. Then, find each area. Use the measurements below to match and label the rooms.

Kitchen/Living Room: 78 square centimeters

Bedroom: 48 square centimeters

Bathroom: 24 square centimeters

Hallway: 6 square centimeters

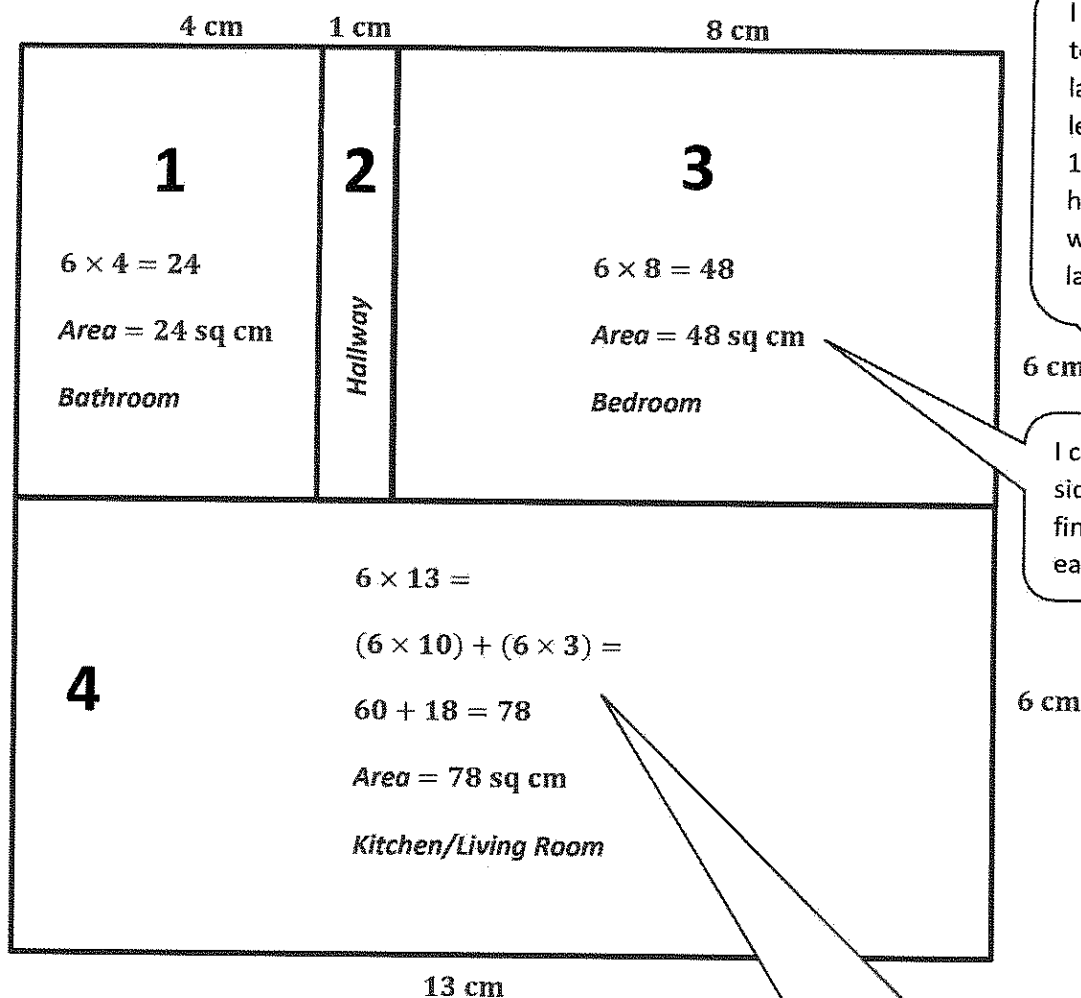

I can use my ruler to measure and label the side lengths. Rooms 1, 2, and 3 all have the same width, so I only labeled it once.

I can multiply the side lengths to find the area of each room.

I can use the break apart and distribute strategy to find the area of Room 4.

Area of Room 2:

$$6 \times 1 = 6$$

$$\text{Area} = 6 \text{ sq cm}$$